



TS35 PROFIX CLADDING SYSTEMS

Profix TS35 Concealed fixed, flat panel façade system is a unique aluminium multi rail system specifically designed for use with **Trespa® Meteon®** panels. Profix Systems are tested to AS/NZS 4284 and compliant with the requirements of NZBC sections B1 Structure, B2 Durability and E2 External Moisture.

The **Profix TS35** multi rail system accounts for trans-directional movement between the panel and the built substrate. Panels are attached to a specifically designed rail system with concealed mechanical fixings and vertical adhesive bond lines. Even the differential movement between the panel and the rail has been considered.

Profix TS35 rails are fixed independently to a 35mm timber cavity batten providing a 70mm wide cavity that enables the façade to be fixed without penetrating the air seal or framing.

Profix TS35 drains and ventilates at every horizontal joint where a specifically designed rail is fixed to the back of the panel providing mechanical support to the Sika Tack adhesive system. Panels are ship-lapped at vertical joints to effectively weatherproof the joint whilst allowing for movement between panels. Panels can be oriented in different directions for distinctive visual effects across a façade face.

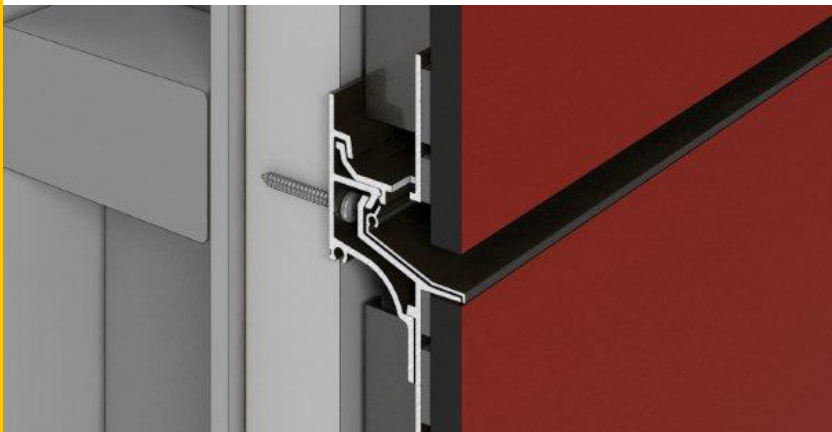

Profix TS35 is further enhanced with an extensive range of Trespa® Meteon® colours and a full range of anodised flashing components for windows and internal and external corners.

SCOPE: WHERE TO USE TS35

- Suitable for use as a residential or commercial cladding façade up to 4 levels
- Fixed over a Rigid Air Barrier compliant with NZBC E2/AS1/ Table 23: 1 August 2011 and NZS 3604: 2011
- Approved for use in wind zones up to 2.5 kPa ULS wind pressure or 64.5 m/s with reference to AS/NZS 4284
- For use in wind zones exceeding 2.5kPa wind pressure the system and fixings must be specified as site specific by the system suppliers
- Suitable for use in all environments including sea spray and geothermal zones
- Suitable for use with 10mm Trespa® Meteon® in panel sizes up to 3.0m x 1.2m horizontally and 2.5m x 1.2m vertically
Note: The use of 8.0mm Trespa® Meteon® panel and panel sizes exceeding those noted above must be specified as site specific by the system suppliers

BENEFITS: WHY USE TS35

- Warranted system that is tested to AS/NZS 4284 and compliant with the requirements of NZBC sections B1 Structure, B2 Durability and E2 External Moisture
- Trespa® Meteon® is a core cured homogenous HPL façade panel that is manufactured using Trespa's unique Electron Beam Curing process resulting in a panel that has surface and core durability with an extremely high delamination strength
- Trespa® Meteon® is a prefinished panel that is graffiti resistant and offers exceptional impact resistance
- For use with 10mm (or 8.0mm on approval from Décortech) Trespa® Meteon® panels that are available in an extensive colour range with proven durability and colour fastness
- The Profix TS35 rail system is durable, lightweight and can span between fixings allowing the rail to be packed straight and true
- The 35mm timber cavity batten thickness can be increased to 45mm allowing for straightening of existing substructures outside the air seal

- TS35 offers minimal maintenance and exceptional through life performance
- All fixings are concealed
- The Sika Tack adhesive system, with additional concealed mechanical fixing gives a clean, flat and straighter finish to your façade
- Exposed mechanical fixings (wafer head coloured 304 stainless steel screws or coloured structural rivets) can be used
- Suitable for use as a cladding solution on new buildings and façade upgrades
- Supply and installation is carried out by Approved Installers only

COMPLIANCE: WITHIN THE NEW ZEALAND MARKET PLACE

- Tested and compliant with AS/NZS 4284:2008 Testing of Building Facades
Fletcher Aluminium Laboratory Test Report No. T393
- Tested and compliant with NZBC E2/VM1 Verification Method
Fletcher Aluminium Laboratory Test Report No. T394
- Les Boulton & Associates Durability Appraisal Report No. 11976
- Façade Design Services PS2 Report No. FD221
- Trespa® Meteon® Grey Scale Rating (Florida cycle) of 4-5
- Trespa® Meteon® Product Guarantee 10 yrs

